

# Magnetic AP-MM Asphalt Release Foam System

MODEL # 977941

## OVERVIEW

The Magnetic AP-MM Asphalt Release Foam System is a magnetic sensor activated foam applicator that mounts to a user-supplied drive-through arch for applying asphalt release chemicals to truck beds. It is designed for facilities with low or fluctuating water pressure. This system uses compressed air to drive a rugged Sandpiper air-operated, double-diaphragm pump which draws chemical concentrate and water from separate static tanks and blends them "on-the-fly" to create an accurately diluted solution. Rich, clinging foam is created by injecting compressed air into the solution to greatly expand volume and coverage ability. When a truck comes into range of the magnetic sensor, a delay timer allows the driver to position the truck under the foam bar before foaming begins and a run timer applies chemical for a pre-set time or until the vehicle leaves the foaming area, whichever is first.

## Key Features

- Projects asphalt release chemicals on to truck beds from a foam bar that attaches to an existing drive-through bar
- Rich, clinging foam increases chemical contact time and coverage for maximum effectiveness
- The rugged Sandpiper AODD pump draws chemical concentrate and water from separate static tanks and blends them "on-the-fly"
- The magnetic sensor activated, adjustable, single-shot timer will delay for up to 6 minutes, allowing the driver to get in position, and then apply chemical for up to 6 minutes before shutting off
- Magnetic sensor with adjustable sensitivity eliminates potential alignment issues associated with electric eyes (photocell sensors)
- The driver remains in his cab and avoids the risk of slip-and-fall injury and chemical waste
- Evenly coats the truck bed in just seconds, reducing run-off and chemical waste
- A float valve assembly attaches to, and automatically refills, a user-supplied static water tank
- Achieves a wide range of dilution ratios using a metering manifold to control chemical and water flow
- Chemical resistant wetted components ensure years of outstanding performance with minimal maintenance
- Available as a spray applicator (#977845)
- See other Lafferty asphalt release equipment and industrial chemical applicators in [Catalog 8](#)

## Includes

- Lockable, stainless steel pump enclosure
- Control box with delay/run timers & magnetic sensor
- 1/2" Sandpiper AODD Pump (Santoprene diaphragms)
- Machined polypropylene metering manifold
- Machined polypropylene foamer body
- Water tank float valve assembly
- 40' discharge hose and PVC foam bar with 4 fan nozzles

## OPTIONS

### Heater Assembly

Retro-Fit Heater Assembly # 720981

### Drum & Tote Stick Lengths & Seal Materials

Drum Stick, 33" (Viton or EPDM)	# 491643 / 491643-E
Drum Stick, 48" (Viton or EPDM)	# 491648 / 491648-E
Drum Stick, 54" (Viton or EPDM)	# 491645 / 491645-E
Tote Stick, 33" (Viton or EPDM)	# 491653 / 491653-E
Tote Stick, 48" (Viton or EPDM)	# 491654 / 491654-E
Tote Stick, 54" (Viton or EPDM)	# 491656 / 491656-E

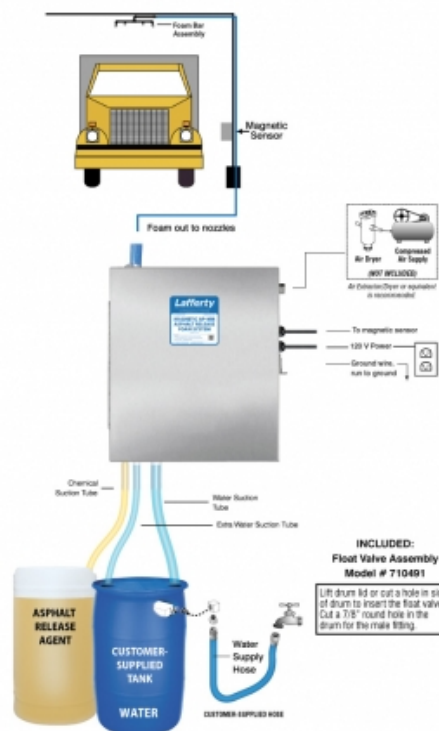

## REQUIREMENTS

Chemical Concentrate  
Static Tank of Water

Compressed Air up to 10 CFM

Minimum Air Supply Line 3/8"

Hose 3/4" ID x 40'

Nozzle #180193SS

Electric 120V

## APPLICATIONS

- Asphalt

**Lafferty**  
EQUIPMENT MANUFACTURING LLC  
CFS TECHNOLOGIES

1.501.851.2820 | 1.800.999.2820  
www.laffertyequipment.com