

RADAR™ Single Eye AP-MM Spray System

MODEL # 977840

OVERVIEW

The RADAR™ Single Eye AP-MM Spray System is a photoelectric sensor-activated, time delayed, asphalt release applicator that mounts to a user-supplied drive-through arch for spraying asphalt truck beds. This system uses a rugged Sandpiper air-operated, double-diaphragm pump to draw chemical concentrate and water from separate static tanks and blend them "on-the-fly" to create an accurately diluted solution. When a truck comes into range of the single-eye, diffuse-reflective photoelectric sensor, a delay timer allows the driver to position the truck under the nozzle before spraying begins and a run timer limits application to a pre-set time period or until the vehicle leaves the spraying area, whichever is first.

Key Features

- Designed to spray asphalt release chemicals on to truck beds from a nozzle that attaches to an existing drive-through spray bar
- The rugged Sandpiper AODD pump draws chemical concentrate and water from separate static tanks and blends them "on-the-fly"
- "Single eye" sensor eliminates potential alignment issues associated with dual eye (through-beam) photoelectric sensors and magnetic sensors
- Diffuse-reflective photoelectric sensor with 10' range
- The system delays for an adjustable length of time when a truck approaches the sensor, allowing the driver to position the truck before activating for an adjustable, pre-set length of time
- Spraying will stop if the driver leaves the area early
- The driver remains in his cab and avoids the risk of slip-and-fall injury and chemical waste
- Evenly coats the truck bed in just seconds, reducing run-off and chemical waste
- A float valve assembly attaches to, and automatically refills, a user-supplied static water tank
- Achieves a range of dilution ratios using a metering manifold to control chemical and water flow
- Chemical resistant wetted components ensure years of outstanding performance with minimal maintenance
- See other Lafferty asphalt release equipment and industrial chemical applicators in [Catalog 8](#)

Includes

- Lockable, stainless steel pump enclosure
- 1/2" Sandpiper AODD Pump (Santoprene diaphragms)
- Machined polypropylene metering manifold
- Control box with delay/run timers
- Enclosed photoelectric sensor
- Water tank float valve assembly
- 40' discharge hose with custom fan spray nozzle

OPTIONS

Heater Assembly

Retro-Fit Heater Assembly # 720981

Drum & Tote Sticks (Viton Seals)

EPDM seals: Add "-E" to model number

33" Drum / Tote Stick # 491643 / # 491653

48" Drum / Tote Stick # 491648 / # 491654

54" Drum / Tote Stick # 491645 / # 491656

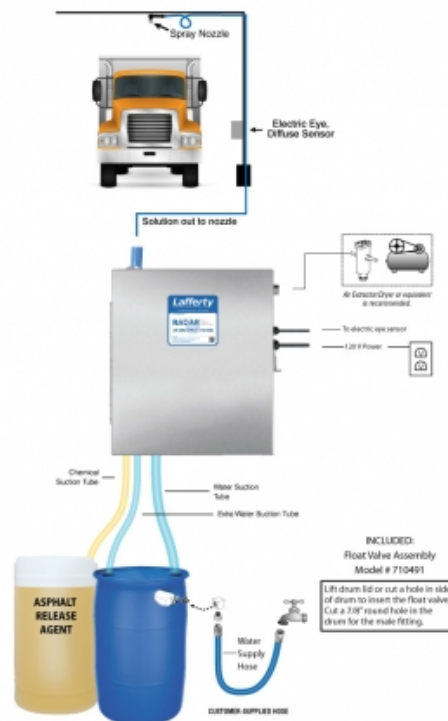

RADAR™

RAPID DRIVE THRU ASPHALT RELEASE

REQUIREMENTS

Chemical Concentrate
Static Tank of Water

Compressed Air up to 10 CFM

Minimum Air Supply Line 3/8"

Hose 3/4" ID x 40'

Nozzle #180193SS

Electric 120V



Asphalt Release Spray Nozzle Assembly

Provides a coarse, wide fan spray pattern for quick, complete coverage.

Lafferty
EQUIPMENT MANUFACTURING LLC
CFS TECHNOLOGIES

1.501.851.2820 | 1.800.999.2820
www.laffertyequipment.com