

Model 40 SS Bypass 2-Way Airless Foamer / Sprayer

MODEL # 969755

OVERVIEW

The Model 40 SS Bypass 2-Way Airless Foamer/Sprayer is a wash/rinse system for quickly applying two chemicals and rinsing through the same hose. Using a 5 - 8 GPM pressure washer, this stainless steel venturi injection system draws and blends two separate chemicals or two different concentrations of the same chemical into the water stream to create an accurately diluted solution. The solution is then projected through the discharge hose and foam wand where it draws in atmospheric air to create wet, clinging foam. Use the spray nozzle to apply non-foaming chemicals and simply open the bypass ball valve to rinse at full volume and pressure.

OPTIONS

Stainless Steel Hose Racks

Large Stainless Steel Hose Rack

224150

Stainless Steel Jug Racks Available

Safe Flow Lid™ for 1 Gallon Jugs

Lid, Suction Tube, and Strainer

709101

Pressure Washer Hose & Trigger Gun

HP 3/8" x 50' Hose & Trigger Gun Kit

807069

Inlet Jumper Hose

Hose, 3/8" x 6', High Pressure

195006

Hose, 3/8" x 15', SS, BNM, High Pressure

195015SS

APPLICATIONS

- Pressure Washing
- Vehicle Detailing
- House and Roof Cleaning
- Agriculture/Horticulture
- Industrial
- And Many Other Applications!

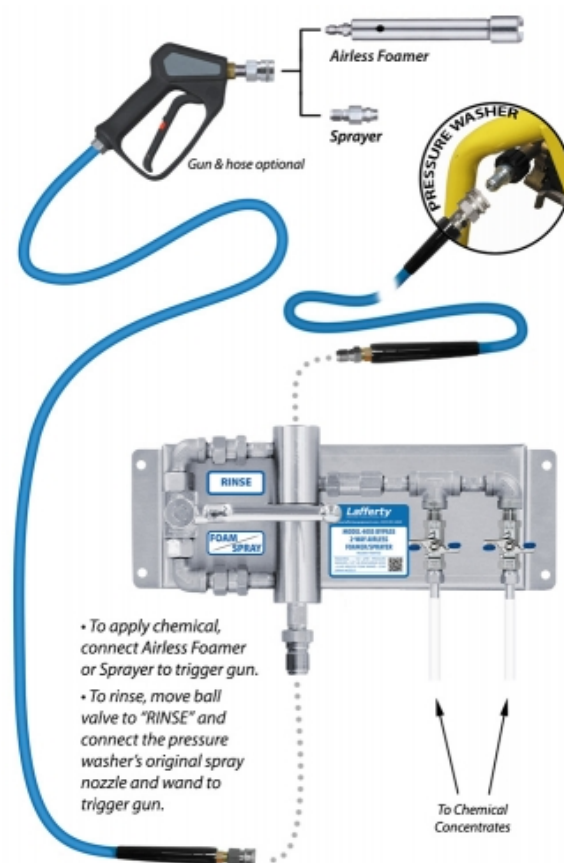

REQUIREMENTS

Chemical Concentrate

Water

Temperature up to 180°F
 Pressure 125 to 350 PSI
 Flow 2.2 GPM @ 150 PSI

Hose

3/8" ID x 50'

Nozzle

A41 Airless Foam Wand