

Lafferty Equipment Manufacturing, LLC Installation & Operation Instructions

Model # 950850 · Pump Fed Fogger Zone Control Kit

REQUIREMENTS

Controller to regulate air-operated solenoids	3 or 6-Zone PLC Vision Controller
Solution piping to foggers	1/2" ID
Air piping to foggers	1" ID

OPTIONS

Metered Bleed Assembly Required for Off-Gassing Chemicals	# 950852
--	----------

Optional Stainless Steel Solenoids PF Fogger Zone Control Kit W/ SS Solenoids	# 950850SS
--	------------



www.laffertyequipment.com
501-851-2820

**WARNING! READ ALL
INSTRUCTIONS BEFORE
USING EQUIPMENT!**

OVERVIEW

Pump Fed Fogger Zone Control Kits are used in conjunction with a PLC Vision Controller to operate Pump Fed Foggers in multiple zones. Air-activated solenoids receive a compressed air signal from the controller (sold separately) to regulate the flow of compressed air and chemical solution to the foggers. A Bleed Tank Assembly keeps the air line open momentarily to clear residual chemical solution from fogger heads to prevent dripping after the solution flow is deactivated.

SAFETY & OPERATIONAL PRECAUTIONS

- Manufacturer assumes no liability for the use or misuse of this unit.
- Wear protective clothing, gloves and eye-wear when working with chemicals.
- Always direct the discharge away from people and electrical devices.
- Follow the chemical manufacturer's safe handling instructions.
- Carefully follow chemical manufacturer's safe handling instructions and recommended precautions/practices when using flammable chemicals.
- **CAUTION: Foggers atomize chemical into the air. Ensure that the area to be fogged has been evacuated of all people and/or animals before commencing chemical fogging operation. Upon completion of fogging, ensure that sufficient time has elapsed for all the fog to have dissipated before returning to the area without proper respiratory protection.**
- **SPECIAL CAUTION: When fogging with off-gassing chemicals, such as peracetic acid, a Metered Bleed Assembly is required. This relieves pressure in the solution line when fogging has been completed and can be installed at any convenient point within each zone.**

Tip Color	Approx. Air Bleed Time
Brown	70 seconds
Clear	50 seconds
Purple	30 seconds
White	20 seconds
Pink	10 seconds

TO INSTALL (REFER TO DIAGRAM ON NEXT PAGE)

1. Ensure that the air and chemical solenoids match facility piping (see requirements).
 2. Install the air and solution solenoids on the air and solution piping to create isolated fogging zones (see diagram).
 3. Connect one of the push-lock fittings on the Bleed Tank Assembly inlet tee to the air-control line from the controller. The Bleed Tank Assembly will be between the controller and the solenoid. Observe the air flow direction label.
 4. Connect the air solenoid to the push-lock tubing on the Bleed Tank Assembly discharge tee.
 5. Connect the solution solenoid to the unused push-lock fitting on the Bleed Tank Assembly inlet tee.
 6. If using off-gassing chemicals, such as PAA, install a Metered Bleed Assembly (not included) on the solution line downstream of the solution solenoid near the foggers.
-
1. Metering tips regulate how long the Bleed Tank Assembly will keep the air solenoid open after the solution solenoid closes.
 2. Select the tip color that is closest to your desired air bleed time and thread it into the tip holder on the Bleed Tank Assembly discharge tee. **DO NOT OVER-TIGHTEN.**

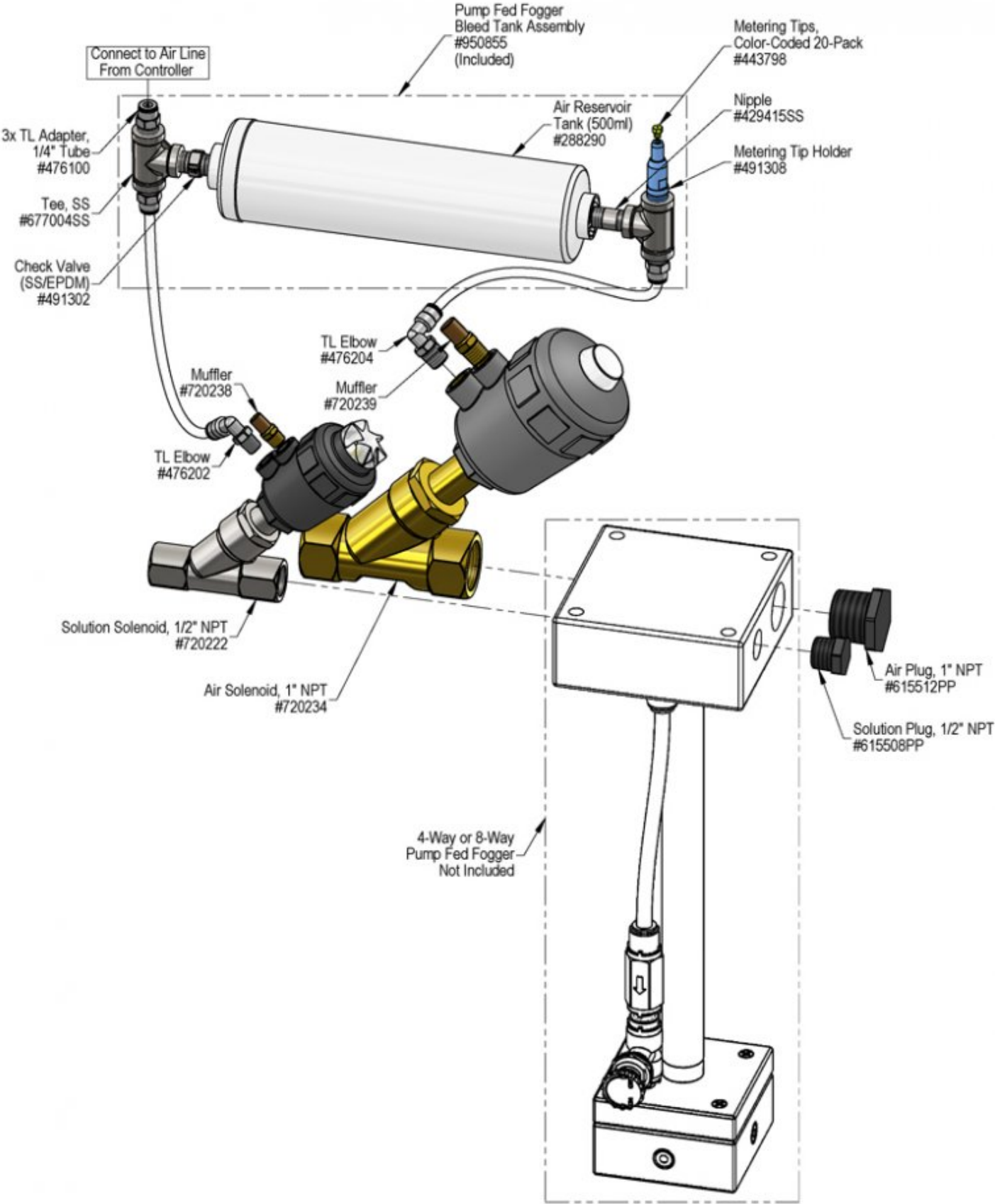

This page intentionally left blank.

