

Satellite PF Entryway XV Foam Sanitizer

MODEL # 976642

OVERVIEW

The Pump Fed Satellite Entryway HV Foam Sanitizer is an automated foam applicator for projecting sanitizing chemicals on to floors of 8'-16' wide/overhead doors to prevent cross contamination. When activated, this system is fed with RTU chemical solution from a central chemical feed system. Rich, clinging foam is created by injecting compressed air into the solution to greatly increase volume and coverage ability. Foam is then projected through the two discharge hoses and HV Spreader™ nozzles. Up to 10 Satellite units are activated and operated by compressed air from a timed Entryway Satellite Controller - no electrical connection is required at the entryway location. All units will activate and deactivate at the same time.

Key Features

- Applies a layer of rich, clinging foam to entryway floors to prevent cross-contamination
- Designed for 8'-16' wide/overhead doors
- Fed with ready to use chemical solution from a central chemical pumping system
- The two unique HV Spreader™ nozzles lay a combined foam pattern 8'-16' across and up to 10' wide to ensure all foot traffic and cart wheels are fully exposed to the sanitizer
- Automatic activation and shutoff for use in moderate to high traffic areas
- Activated and operated by compressed air from the Satellite Controller - no electrical connection required at the entryway door.
- Adjustable foam consistency (wet/dry)
- Chemical resistant wetted components ensure durability and years of reliable service with minimal maintenance
- Choice of two Satellite Controllers:
 - **Timed Entryway Satellite Controller** - An adjustable recycle timer applies foam at regular, timed intervals.
 - **PLC Jazz Entryway Satellite Controller** - A pre-programmed PLC Controller allows variable settings for hours of operation and peak traffic demands.
- Available for smaller doors (#976640, 976641)
- See [Catalog 6](#) for other entryway configurations

Includes

- Stainless steel mounting plate
- Stainless steel solution activation solenoid
- Machined polypropylene foamer body
- Foam enhancer
- 10' discharge hose
- (2) HV Entryway Spreader™ nozzles (must use both)

OPTIONS

Regulate the Operation of Multiple Satellite Entryway Foam Sanitizers

Timed Entryway Satellite Controller (120V)	# 976625
Timed Entryway Satellite Controller (24V)	# 976625-24V
PLC Jazz Entryway Satellite Controller (120V)	# 976630
PLC Jazz Entryway Satellite Controller (24V)	# 976630-24V

Central Pump Systems (AODD)

Mini-Central Pump System (1/2" PP)	# 919050
Central Pump System (1" SS)	# 919060SS

High Flow Level Masters Provide an Automatic Supply of Ready-to-Use Chemical

60/10 High Flow Level Master	# 989106
60/20 High Flow Level Master	# 989108

Foam Solution Check Valves & Strainer

Check Valve, PP, 1/2" (EPDM)	# 491409
Check Valve, PP, 1/2" (Viton)	# 491411
Check Valve, 316SS, 1/2", MF (Teflon)	# 491348SS-T
Strainer, "Y", SS, 1/2" MF	# 150350-1

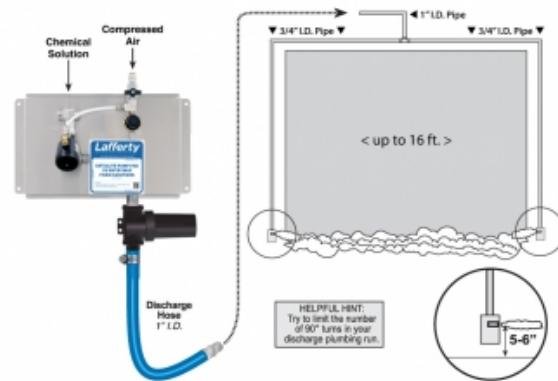

REQUIREMENTS

Ready-to-Use Chemical Solution

Temperature	up to 160°F
Pressure	35 to 100 PSI
Flow	4 GPM @ 40 PSI
Supply Line	1/2" Min

Compressed Air

up to 6 CFM

Hose/Pipe

1" & 3/4" ID

Nozzle

HV Entryway Spreader (2 - use both)

APPLICATIONS

- Agriculture/Horticulture
- Animal Health
- Dairy
- Food & Beverage
- Hatchery
- Pharm/Bio
- And Many Other Applications!

Lafferty
EQUIPMENT MANUFACTURING LLC
CFS TECHNOLOGIES

1.501.851.2820 | 1.800.999.2820
www.laffertyequipment.com